

golftool sg3000

INSTALLATION INSTRUCTION

What's In The Package

1. Frame
2. Wooden plate
3. Nuts/Screws/Washers - 6 pcs.
4. 2 balls/ropes, one for driver one for irons
5. Sandbag
6. Plastic Clamps for the rope - 2 pcs.
7. Impact-masking tape
8. "Velcro" hook stripes
9. Hitting mat
10. Wrench

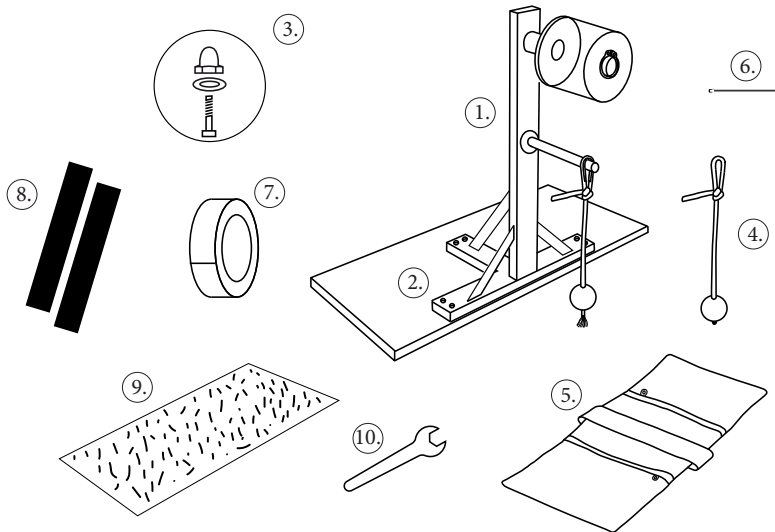

golftoolsg3000

Installation

1. Attach self adhesive velcro strips to a piece of a sturdy carpet or artificial grass (not provided) - about 130 cm x 200 cm.

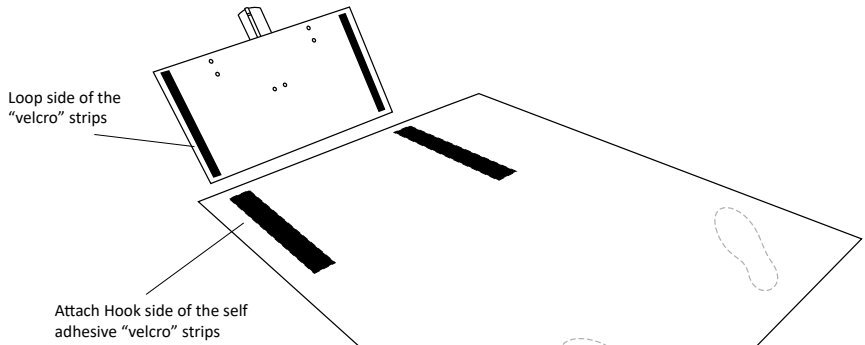

2. Attach the device to the carpet aligning the velcro strips • Attach the sandbag to the device for additional stability if needed.

Removing the groover: lift the back side of the device along with the carpet and gradually detach the velcro strips.

